

# UNI-FLO DOUBLE DOOR WAFER CHECK VALVE PN16 FIG 301

## DESCRIPTION

The Uni-Flow Double Door Check Valve is a compact wafer design and is a popular choice when space is a major factor in valve selection and pipeline design. The compact design features a non-slam spring-assisted closing and is suitable for water, waste water, oil, weak acids and alkaline liquids etc. Tight closure is obtained by utilising a soft seat in either EPDM or NBR.



Pressure Rating (Mpa)	PN16	PN25
Seat Test Pressure (Mpa)	1.76	2.75
Body Test Pressure (Mpa)	2.4	3.75

Suitable Temperature (°C)	EPDM: -10 to +120°C
	NBR: -10 to +80°C
Suitable Medium	VITON: -10 to +150°C
	fresh water, sea water, waste water, foodstuff, steam, oil, weak acid & alkaline liquid, etc

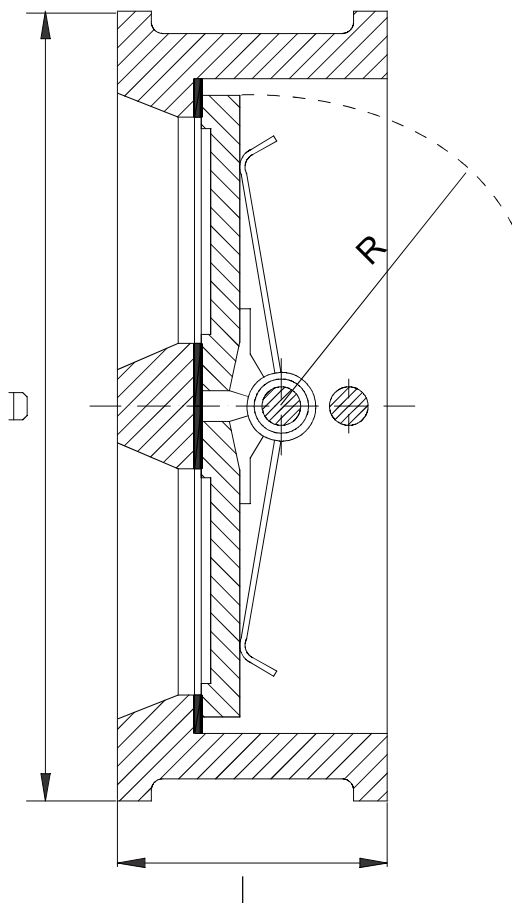

## MATERIALS LIST

NO	PART	MATERIAL	STANDARD
1	Body*	Cast Iron	Gr450/10
		Ductile Iron	Gr450/10
		Stainless Steel	
		Steel	Gr450/10
2	Disk	Stainless Steel	LG2
		AL Bronze	LG2
		Carbon Steel	Gr431S29
3	Seat Gasket	EPDM	
4	Axle	Stainless Steel	
5	Spring	Stainless Steel	
6	Washer	Teflon	

## DIMENSIONS

DN (mm)	D	L	R	CV
50	96	43	28.8	80
65	109	46	36.1	90
80	128	64	43.4	150
100	160	64	52.8	300
125	191	70	65.7	500
150	218	76	78.6	900
200	274	89	104.4	1700
250	328	114	127	3000
300	378	114	147	4000
350	438	127	172.4	5350
400	489	140	197.4	7400
450	532	152	217.8	10000
500	585	152	241	13000
600	690	178	295.4	24000

Designed according to EN 12334

# UNI-FLO FIG.301

## OPTIMUM INSTALLATION

In a horizontal pipe, the check valve must always be installed with its hinge in the vertical position

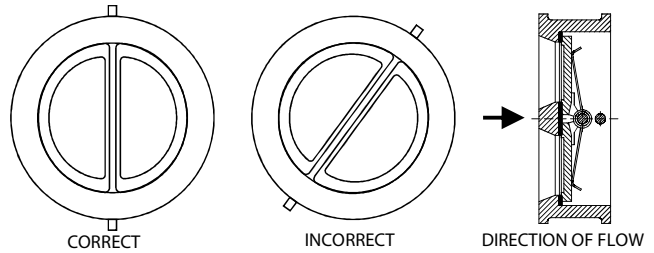

In a piping system, some minimum distances must be respected between the check valve position and a bend or a tee.

The following drawings show some horizontal pipe configurations (viewed from above) in which the check valve is installed with its hinge in the vertical position.

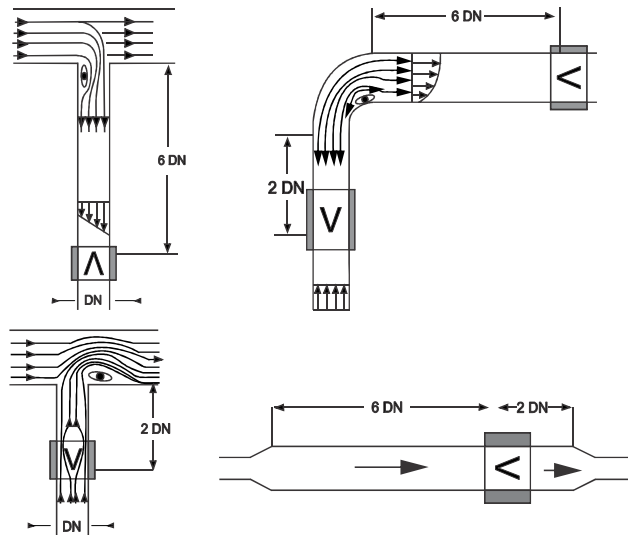

The minimum recommended distance for a check valve installed downstream from a bend, tee, pump or valve causing flow disturbance is 6 diameters.

When such a unit downstream of the check valve, it is necessary to respect a distance of at least 2 diameters.

## PRESSURE DROPS IN WATER FLOW

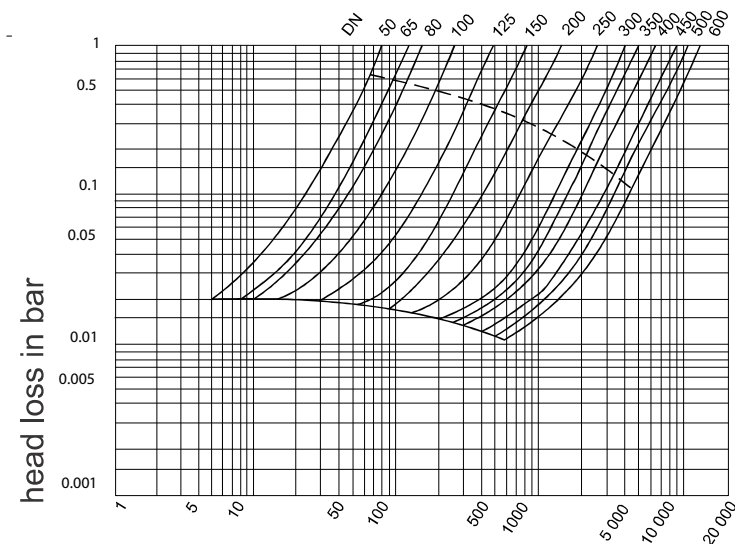

The curves in continuous line define the flow range for the optimum use of the check valve.

## HYDRAULIC CHARACTERISTICS

FLOW COEFFICIENT FULL OPEN POSITION			FLOW COEFFICIENT FULL OPEN POSITION		
DN	Kv	Cv	DN	Kv	Cv
50	75	87	250	2308	2668
65	112	130	300	3863	4466
80	141	163	350	4616	5336
100	240	278	400	6020	6960
125	450	522	450	8529	9860
150	750	870	500	10034	11600
200	1300	1508	600	12543	14500

Units: Kv in m<sup>3</sup>/h/bar<sup>1/2</sup> - Cv in gallon/mn/PSI<sup>1/2</sup>